

EROUND line news

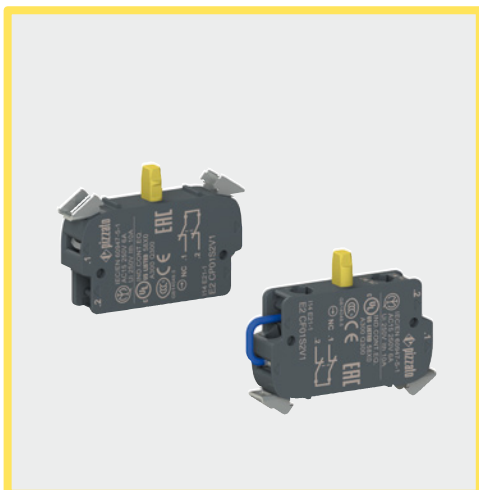

EROUND



Main features

- Self-monitored contact block. Electrical circuit opening indicates separation from the device
- Gold plated contacts version
- Positive opening NC contacts according to IEC 6097-5-1

Markings and quality marks:



Approval IMQ: CA02.04805
 Approval UL: E131787
 Approval CCC: 2007010305230000
 Approval EAC: RU C-IT DM94.B.01024

Technical data

General data

Protection degree: IP20 on the terminals according to IEC 60529
 Ambient temperature: -40°C +80°C
 Mechanical endurance: 20 million operations cycles¹
 Max operating frequency: 3600 operations cycles¹/hour
 Utilization requirements: see page 3/98, general catalog 2013-2014

(1) One operation cycle means two movements, one to close and one to open contacts, as foreseen by EN 60947-5-1 standard.

Contact block

Contacts commutation force: 2.9 N
 Actuating force at end travel: 5 N
 Positive opening force: 17 N
 Actuation speed: min 1 mm/s
 max 0.5 m/s
 Contacts material: silver contacts (standard)
 Contacts for weak current in silver, 1µm thick gold-plating (on request)
 "V shape" self-cleaning contacts with quadruple contact points
 Conductors cross section: min 1 x 0.34 mm² (1 x AWG 22)
 max 2 x 1.5 mm² (2 x AWG 16)
 Screw terminal driving torque: 0.6 ... 0.8 Nm

In conformity with standards:

IEC 60947-1, IEC 60947-5-1, IEC 60204-1, EN 60947-1, EN 60947-5-1, EN 60204-1, UL 508, CSA 22-2 N°14.

⚠ Installation for safety applications:

Use only switches marked with the symbol ⊕. The safety circuit must always be connected with the **NC contacts** (normally closed contacts: .1-.2) as stated in the standard ISO 14119, par. 5.4.

In conformity with requirements requested by:

Low Voltage Directive 2006/95/EC, Machinery Directive 2006/42/EC and EMC Directive 2004/108/EC.

Positive contact opening in conformity with standards:

IEC 60947-5-1, EN 60947-5-1, VDE 0660-206.

Electrical data

Thermal current (I_{th}): 10 A
 Rated insulation voltage (U_i): 250 Vac/dc
 Protection against short circuits: fuse 10 A 500 V type gG/gL
 Rated impulse withstand voltage (U_{imp}): 4 kV
 Pollution degree: 3

Utilization categories

Alternate current: AC15 (50-60 Hz)

U _e (V)	24	48	120	250
I _e (A)	6	6	6	6

 Direct current: DC13

U _e (V)	24	48	125	250
I _e (A)	2.5	1.3	0.6	0.3

Operation of self-monitored contact blocks

The self-monitored contact block, by opening the electrical circuit, automatically detects the separation either of the fixing adapter from the activating device or the separation of the contact block from the fixing adapter.

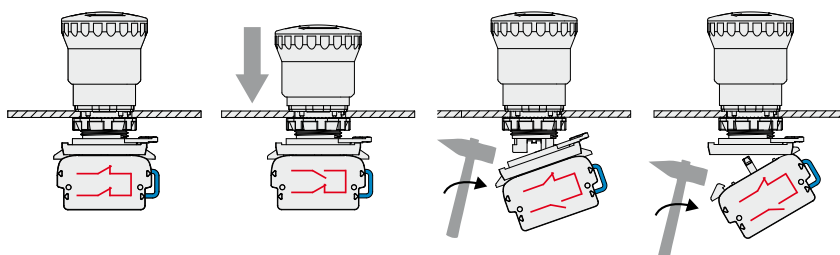

RUN
Correct installation

STOP
Correct installation

Detection of contact block release

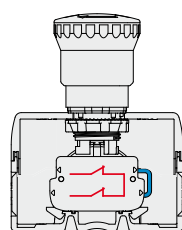

RUN
Correct installation

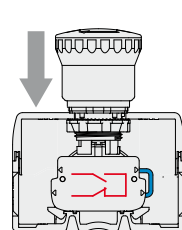

STOP
Correct installation

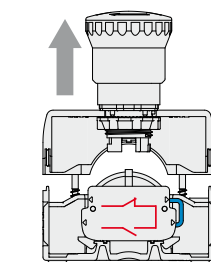



Detection cover opening

In box-mounted versions, the self-monitored contact block detects the removal of the pushbutton or the opening of the cover.

Contact block selection table

5 pcs packs



Contact block	Panel fixing Screw connection
1NC  slow self-monitored action	E2 CP01S2V1 2.3 0.8 0 1.1  2.1 5

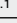

Contact block	Base fixing Screw connection
1NC  slow self-monitored action	E2 CF01S2V1 2.3 0.8 0 1.1  2.1 5

The self-monitored contact block fastened to the bottom of the box can only be mounted in the central position under the device. The central position on the bottom of the box is identified with number 3.

Complete units with contact block and fixing adapter



Contacts			Panel fixing Screw connection
pos 2	pos 3	pos 1	
-	1NC  SELF-MONITORED	-	E2 AC-XXBC0139 E2 1BAC11 + E2 CP01S2V1

Fitting of several single, double and self-monitored contact blocks

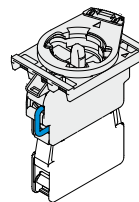

Always install self-monitored contact blocks directly on the fixing adapter.

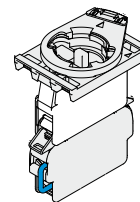

Do not fix self-monitored contact blocks to standard contact blocks. Forbidden application!

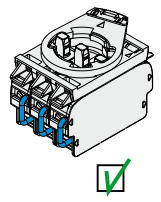

Fix no more than three self-monitored contact blocks per emergency pushbutton.

Dimensions

Panel fixing contact block E2 CP01S...

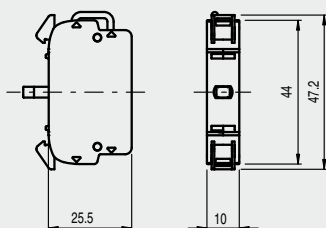

Base fixing contact block E2 CF01S...

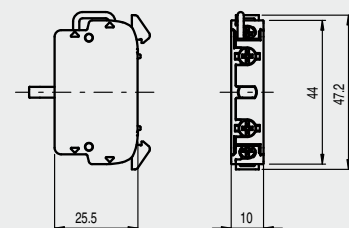

Dust protection

50 pcs packs

	Article	Description
	VE PR3A70	Transparent dust protection for contact block E2 series. Applicable to all contacts fixed on panels.

Items with code on the **green** background are available in stock

Selection diagram

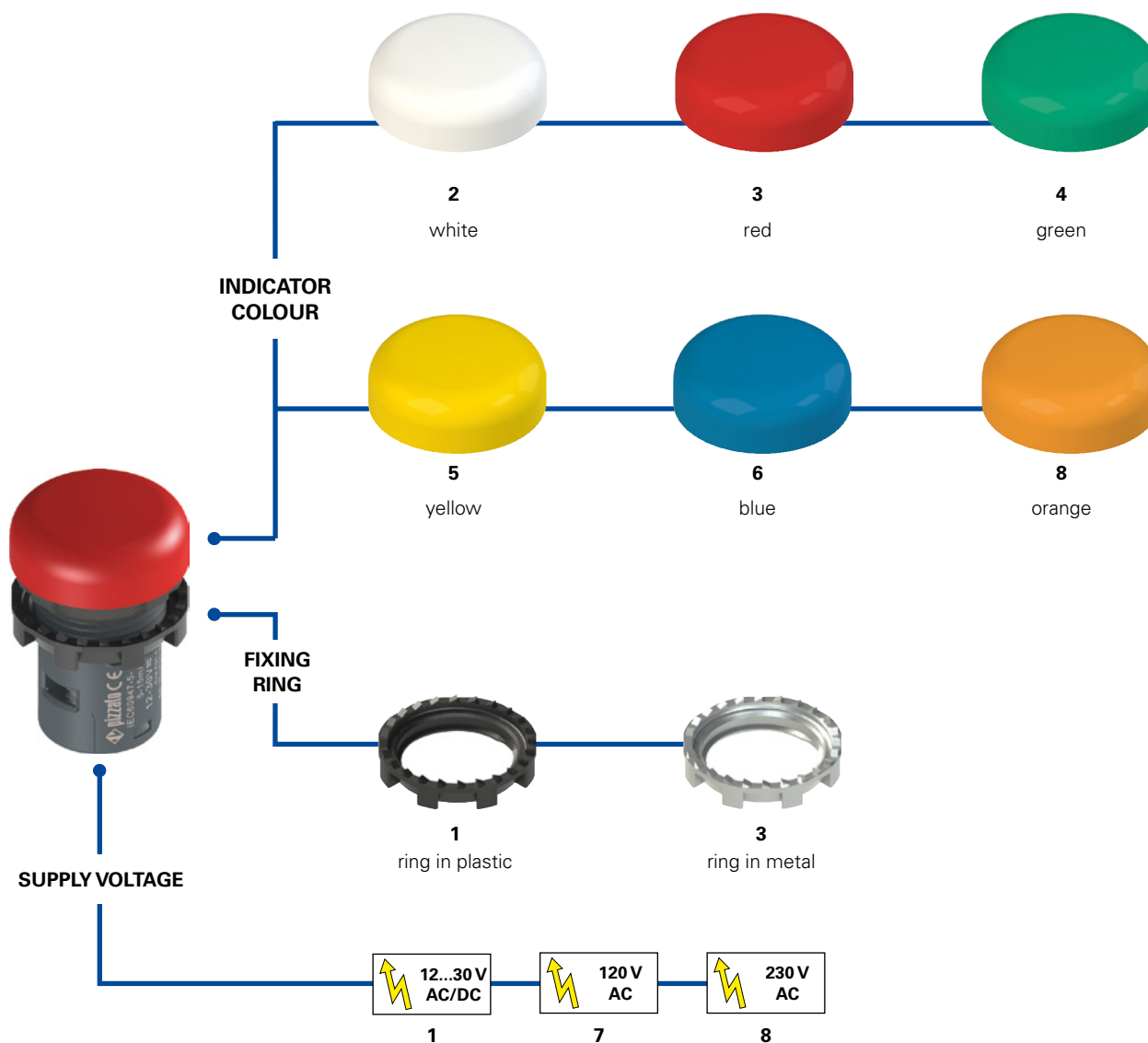

Code structure

E6 1IL1A2110

Fixing ring and shaped ring

1	ring in plastic
2	ring in plastic and shaped ring
3	ring in metal
4	ring in metal and shaped ring

Supply voltages

1	12 ... 30 Vac/dc (high luminosity)
7	120 Vac (standard luminosity)
8	230 Vac (standard luminosity)

Marking

0	without marking (standard)
GB7	RUN
L54	⚡
...

Other markings on request. See page 3/97 of general catalog 2013-2014

Lens colour

2	white
3	red
4	green
5	yellow
6	blue
8	orange

Attention! The feasibility of a code number does not mean the effective availability of a product. Please contact our sales office.



Main features

- Fully integrated indicator light in monolithic body
- Protection degree IP67
- 3 power supply:
12 ... 30 Vac/dc, 120 Vac, 230 Vac
- Optional customisation with symbols

Technical data

General data

Protection degree:	IP67 according to IEC 60529
Ambient temperature:	-40°C +70°C
Endurance:	50.000 hours min. (at rated voltage and ambient temperature +25 °C)
Screw terminal driving torque:	0.8 ... 1 Nm
Fixing ring driving torque:	2 ... 2.5 Nm
Utilization requirements:	see page 3/98 of general catalog 2013-2014

LED holders

Conductor cross section:	min 1 x 0.34 mm ² (1 x AWG 22) max 2 x 1.5 mm ² (2 x AWG 16)
--------------------------	---

Operation voltage and current: (high luminosity)	12 ... 30 Vac/dc; 5 ... 15 mA
---	-------------------------------

Operation voltage and current: (standard luminosity)	102 ... 138 Vac; 2.5 mA 195 ... 264 Vac; 2.5 mA
---	--

In conformity with standards:

IEC 60947-1, IEC 60947-5-1, IEC 60204-1, EN 60947-1, EN 60947-5-1, EN 60204-1, UL 508, CSA 22-2 N°14.

Markings and quality marks:



Approval EAC: RU C-IT DM94.B.01024

In conformity with requirements requested by:

Low Voltage Directive 2006/95/EC, Machinery Directive 2006/42/EC and EMC Directive 2004/108/EC.

High protection degree

IP67

This series indicator lights all have protection degree IP67, this way guaranteeing a total protection also in hard environmental conditions.

Customizing possibilities

In order to suit the various requests and needs of the customers, Pizzato Elettrica offers the possibility to customize the indicator lights with laser inscriptions and symbols.



Screw connection integrated

The shape of the indicator lights type E6, though very compact, allows the integration on the device of all components for proper installation and functioning. All that is required is to insert the device wires by means of its screw terminals, without the need to install further components.

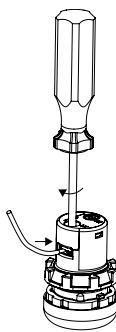



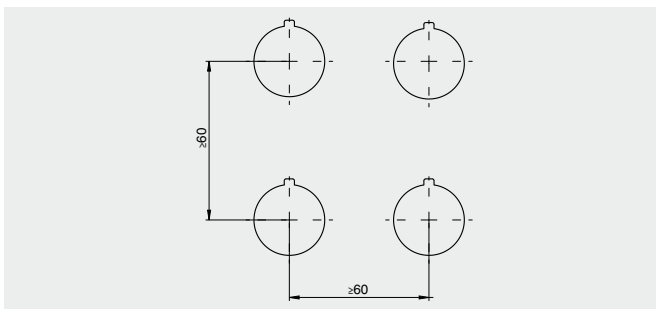

Assembling minimum distances

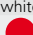

Selection table

10 pcs packs

LED colour	Operation voltage		
	12 ... 30 Vac/dc	120 Vac	230 Vac
 white	E6 1IL1A2110	E6 1IL7A2110	E6 1IL8A2110
 red	E6 1IL1A3110	E6 1IL7A3110	E6 1IL8A3110
 green	E6 1IL1A4110	E6 1IL7A4110	E6 1IL8A4110
 yellow	E6 1IL1A5110	E6 1IL7A5110	E6 1IL8A5110
 blue	E6 1IL1A6110	E6 1IL7A6110	E6 1IL8A6110
 orange	E6 1IL1A8110	E6 1IL7A8110	E6 1IL8A8110

Dimensions

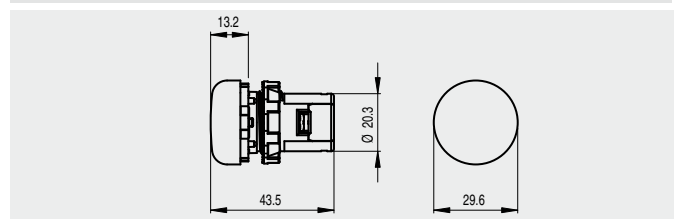

Items with code on the **green** background are available in stock

Selection diagram

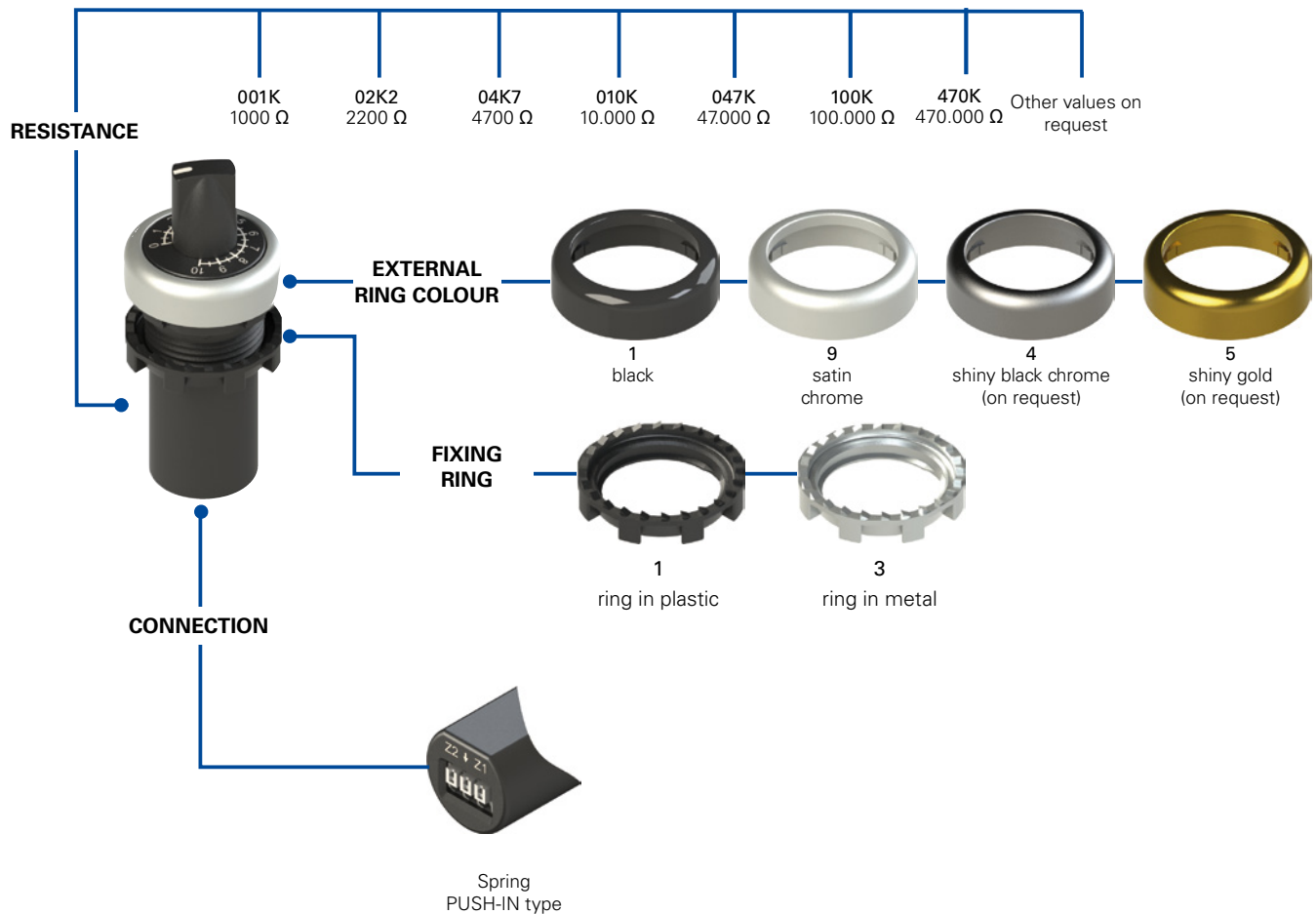

Code structure

E6 1DM02K2-D111

Fixing ring and shaped ring

- | | |
|---|---------------------------------|
| 1 | ring in plastic |
| 2 | ring in plastic and shaped ring |
| 3 | ring in metal |
| 4 | ring in metal and shaped ring |

Ring colour

- | | |
|---|---------------------------------|
| 1 | black (standard) |
| 9 | satin-finish chrome (standard) |
| 4 | shiny black chrome (on request) |
| 5 | shiny gold (on request) |

Resistance

- | | |
|------|------------------|
| 001K | 1000 Ω |
| 02K2 | 2200 Ω |
| 04K7 | 4700 Ω |
| 010K | 10,000 Ω |
| 047K | 47,000 Ω |
| 100K | 100,000 Ω |
| 470K | 470,000 Ω |

Other values on request

Attention! The feasibility of a code number does not mean the effective availability of a product. Please contact our sales office.



Main features

- Fully integrated potentiometer in monolithic body
- Protection degree IP67 and IP69K
- Rotative potentiometer with Cermet technology
- 3-pole PUSH-IN type spring-connection system
- Numerous resistance values

Markings and quality marks:



Approval EAC: RU C-IT DM94.B.01024

In conformity with standards:

IEC 60947-1, IEC 60947-5-1, IEC 60204-1, EN 60947-1, EN 60947-5-1, EN 60204-1, UL 508, CSA 22-2 N°14.

Technical data

General data

Protection degree:	IP67 according to IEC 60529 IP69K according to ISO 20653
Ambient temperature:	-40°C +80°C
Mechanical endurance:	50000 operations cycles
Mechanical stroke:	250°
Ring driving torque:	2 ... 2.5 Nm
Utilization requirements:	see page 3/98, general catalog 2013-2014

Electrical data

Rated insulation voltage (Ui):	300 Vac
Resistive material:	Cermet
Operation:	linear
Resistance tolerance:	±10%
Cross section of solid leads, flexible leads with tip:	min 1 x 0.34 mm ² (1 x AWG 24) max 1 x 1.5 mm ² (1 x AWG 16)
Cross section of leads with pre-insulated tip:	min 1 x 0.34 mm ² (1 x AWG 24) max 1 x 0.75 mm ² (1 x AWG 18)
Connection system:	PUSH-IN type, spring-operated
Cable stripping length (x):	min: 8 mm max: 12 mm

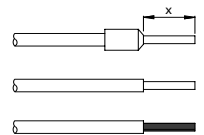
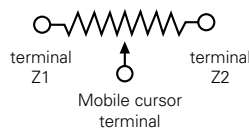

Resistance	Rated operation voltage Ue max	Rated operation current Ie max	Power (70 °C) max
1 kΩ	31 V	31 mA	1 W
2.2 kΩ	46 V	21 mA	1 W
4.7 kΩ	63 V	14 mA	1 W
10 kΩ	100 V	10 mA	1 W
47 kΩ	217 V	4.6 mA	1 W
100 kΩ	316 V	3 mA	1 W
470 kΩ	350 V	0.75 mA	0.25 W

High resistance values are available; contact our technical department

In conformity with requirements requested by:

Low Voltage Directive 2006/95/EC, Machinery Directive 2006/42/EC and EMC Directive 2004/108/EC.

Integrated potentiometer



Thanks to its monolithic shape, it has been possible to integrate all the mechanical and electrical components needed for its end use inside the E6 series potentiometer body; it is therefore not necessary to assemble any other parts, such as knobs or trimmers, all that is required is to insert the circuit wires into the incorporated terminal board. Precise choices made in terms of design and materials have led to the creation of an object featuring remarkable mechanical resistance when in operation and maximum protection preventing any liquids or foreign bodies from penetrating inside.

Moreover, the resistive element used is made of a composite ceramic and metal material, produced with the Cermet technology, which ensures remarkable stability and constancy in the resistance value set.

Protection degree IP67 and IP69K

IP69K
IP67

Designed to be employed also in severe environment conditions, Pizzato Elettrica potentiometers have protection degree IP67 and IP69K, suitable for use in machineries subjected to intense washing with high pressure and high temperature water jets.

PUSH-IN type spring-operated connection

The potentiometer is provided with a 3-pole terminal board with a PUSH-IN type spring-operated connection. This technology allows a very handy quick wiring procedure, since the wire just needs to be inserted into the appropriate hole in order to be secured and to establish the electrical connection. The said operation can be carried out without the help of any tool, but simply using rigid or flexible wires with a crimped tip. Release is obtained by pressing the appropriate wire-releasing push-button.

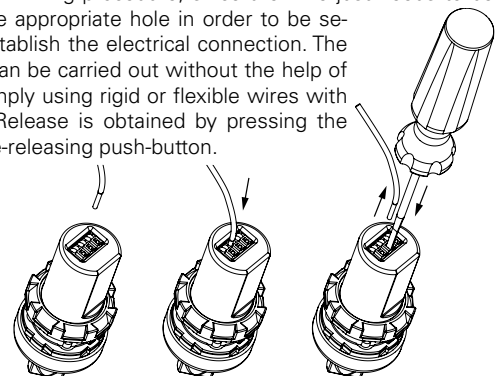

Dimensions

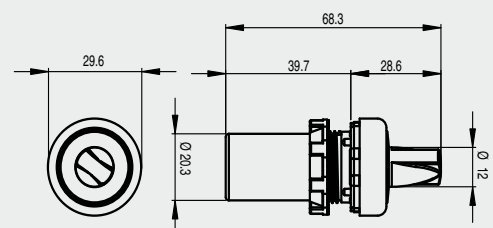

Selection diagram

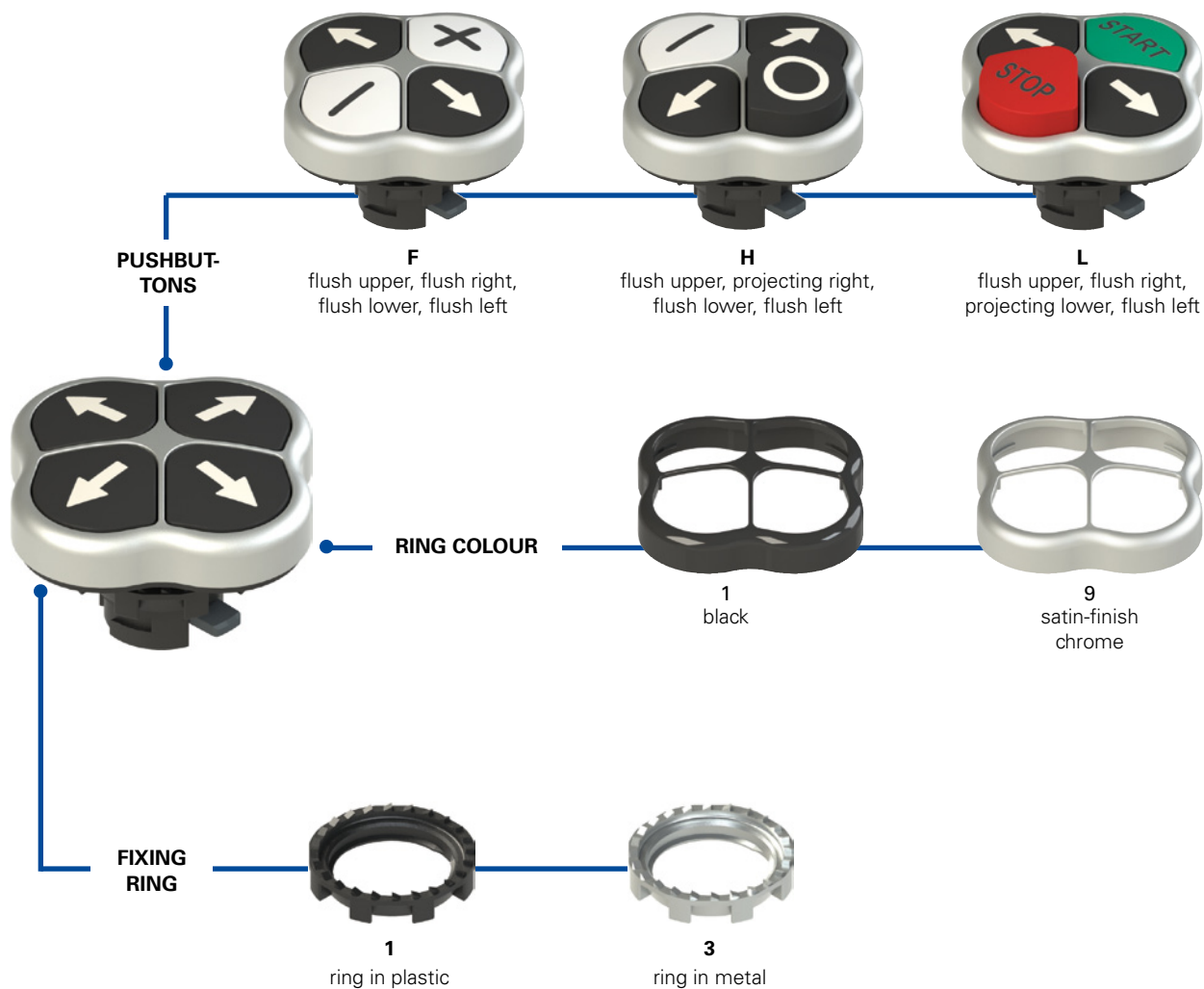

Code structure

E2 1PQFA1QAAA

Fixing ring and shaped ring

1	ring in plastic
3	ring in metal

Pushbuttons

F	flush upper, flush right, flush lower, flush left
H	flush upper, projecting right, flush lower, flush left
L	flush upper, flush right, projecting lower, flush left

Note: Other configurations on request.

Ring colour

1	black (standard)
9	satin-finish chrome (standard)

Colour and markings

	upper pushbutton		right pushbutton		lower pushbutton		left pushbutton	
	colour	symbol	colour	symbol	colour	symbol	colour	symbol
QAAA	black	↑	black	→	black	↓	black	←
QAAB	green	START	black	→	red	STOP	black	←
QAAC	white	START	black	→	black	STOP	black	←
QAAD	green	I	black	→	red	O	black	←
QAAE	white	I	black	→	black	O	black	←
QAAF	white	+	black	→	white	-	black	←
QAAH	black	↑	red	STOP	black	↓	green	START
QAAJ	black	↑	black	STOP	black	↓	white	START
QAAK	black	↑	red	O	black	↓	green	I
QAAL	black	↑	black	O	black	↓	white	I
QAAM	black	↑	white	-	black	↓	white	+
QAAN	black	↑	white	⚠	black	↓	white	⚡



Technical data

General

Protection degree:	IP67 according to IEC 60529
Ambient temperature:	-25°C +80°C
Mechanical endurance:	1 million operations cycles ¹
Max operating frequency:	3600 operations cycles/hour
Actuating force at end travel:	6.5 (without contacts)
Maximum travel:	5 mm
Ring driving torque:	2 ... 2.5 Nm
Utilization requirements:	see page 3/98 of general catalog 2013-2014

(1) One operation cycle means two movements, one to close and one to open contacts, as foreseen by EN 60947-5-1 standard.

In conformity with standards:

IEC 60947-1, IEC 60947-5-1, IEC 60204-1, EN 60947-1, EN 60947-5-1, EN 60204-1, UL 508, CSA 22-2 N°14

Main features

- Protection degree IP67
- Version with projecting pushbutton
- Possibility of customization with symbols

⚠ Installation for safety applications:

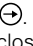
Use only switches marked with the symbol . The safety circuit must always be connected with the **NC contacts** (normally closed contacts: 1-2) as stated in the standard ISO 14119, par. 5.4.

Markings and quality marks:



Approval EAC: RU C-IT ДМ94.В.01024

In conformity with requirements requested by:

Low Voltage Directive 2006/95/EC, Machinery Directive 2006/42/EC and EMC Directive 2004/108/EC.

Positive contact opening in conformity with standards:

IEC 60947-5-1, EN 60947-5-1, VDE 0660-206.

Shape

The new EROUND line quadruple pushbuttons are available in two shapes in order to suit any kind of application: projecting and flush. The possibility to choose shapes, colours and symbols allows various codes combinations.

Mechanical endurance

Thanks to their particular design Pizzato Elettrica quadruple pushbuttons guarantee a mechanical endurance of more than 1.000.000 operations.

Protection degree IP67

IP67

This series quadruple pushbuttons all have protection degree IP67, this way guaranteeing a total protection also in hard environmental conditions.

Customizing possibilities

In order to suit the various requests and needs of the customers, Pizzato Elettrica offers the possibility to customize the quadruple with indelible laser inscriptions and symbols.

Fixing ring

A fixing ring in metal is also available in addition to the fixing ring in technopolymer.

The fixing ring in metal is particularly suitable for those applications which require tighter fitting of the panel-mounted device, such as for example in metal panels having holes without reference notches. Both rings feature a toothed surface which comes into contact with the inside of the panel in order to make it easier for the device to be secured to the actual panel.



Quadruple pushbuttons

Quadruple pushbuttons selection table

Actuator colour and marking (starting from the top and clockwise)		flush upper pushbutton flush right pushbutton flush lower pushbutton flush left pushbutton		flush upper pushbutton projecting right pushbutton flush lower pushbutton flush left pushbutton		flush upper pushbutton flush right pushbutton projecting lower pushbutton flush left pushbutton	
		black ring	satin chrome ring	black ring	satin chrome ring	black ring	satin chrome ring
	black pushbutton black pushbutton black pushbutton black pushbutton	E2 1PQFA1QAAA	E2 1PQFA9QAAA	-	-	-	-
	green pushbutton black pushbutton red pushbutton black pushbutton	E2 1PQFA1QAAB	E2 1PQFA9QAAB	-	-	E2 1PQLA1QAAB	E2 1PQLA9QAAB
	white pushbutton black pushbutton black pushbutton black pushbutton	E2 1PQFA1QAAC	E2 1PQFA9QAAC	-	-	E2 1PQLA1QAAC	E2 1PQLA9QAAC
	green pushbutton black pushbutton red pushbutton black pushbutton	E2 1PQFA1QAAD	E2 1PQFA9QAAD	-	-	E2 1PQLA1QAAD	E2 1PQLA9QAAD
	white pushbutton black pushbutton black pushbutton black pushbutton	E2 1PQFA1QAAE	E2 1PQFA9QAAE	-	-	E2 1PQLA1QAAE	E2 1PQLA9QAAE
	white pushbutton black pushbutton white pushbutton black pushbutton	E2 1PQFA1QAAF	E2 1PQFA9QAAF	-	-	-	-
	black pushbutton red pushbutton black pushbutton green pushbutton	E2 1PQFA1QAAH	E2 1PQFA9QAAH	E2 1PQHA1QAAH	E2 1PQHA9QAAH	-	-
	black pushbutton black pushbutton white pushbutton black pushbutton	E2 1PQFA1QAAJ	E2 1PQFA9QAAJ	E2 1PQHA1QAAJ	E2 1PQHA9QAAJ	-	-
	black pushbutton red pushbutton black pushbutton green pushbutton	E2 1PQFA1QAAK	E2 1PQFA9QAAK	E2 1PQHA1QAAK	E2 1PQHA9QAAK	-	-
	black pushbutton black pushbutton black pushbutton white pushbutton	E2 1PQFA1QAAAL	E2 1PQFA9QAAAL	E2 1PQHA1QAAAL	E2 1PQHA9QAAAL	-	-
	black pushbutton white pushbutton black pushbutton white pushbutton	E2 1PQFA1QAAAM	E2 1PQFA9QAAAM	-	-	-	-

Items with code on the **green** background are available in stock

Complete units



Actuator colour and marking (starting from the top and clockwise)	Contacts				flush upper pushbutton flush right pushbutton flush lower pushbutton flush left pushbutton satin chrome ring
	pos 3	pos 2	pos 4	pos 1	
	black pushbutton "↑"		1NO		E2 AC-DXBC2000 E2 1PQFA9QAAA + E2 1BAC21 + E2 CP10G2V1 + E2 CP10G2V1 + E2 CP10G2V1 + E2 CP10G2V1
	black pushbutton "→"			1NO	
	black pushbutton "↓"		1NO		
	black pushbutton "←"	1NO			



Actuator colour and marking (starting from the top and clockwise)	Contacts				flush upper pushbutton projecting right pushbutton flush lower pushbutton flush left pushbutton satin chrome ring
	pos 3	pos 2	pos 4	pos 1	
	black pushbutton "↑"		1NO		E2 AC-DXBC2001 E2 1PQHA9QAAH + E2 1BAC21 + E2 CP10G2V1 + E2 CP10G2V1 + E2 CP10G2V1 + E2 CP01G2V1
	"STOP" red pushbutton "↓"			1NC ⊙	
	black pushbutton "START" green pushbutton	1NO			
			1NO		

Contacts maximum number

Fixing adapter with 4 positions

Quadruple pushbuttons E2 1PQ●●●●●●●●

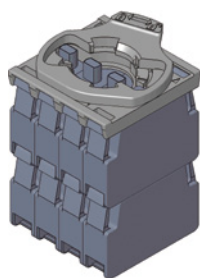

Maximum number:
contacts 8
levels 2

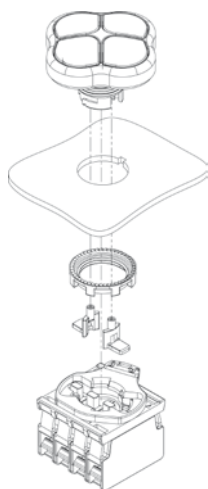

The assembly of the two lateral actuators, supplied with the quadruple button, must be done after the fixing of the pushbutton.

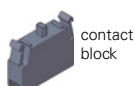

contact block

Dimensions

Flush quadruple pushbutton

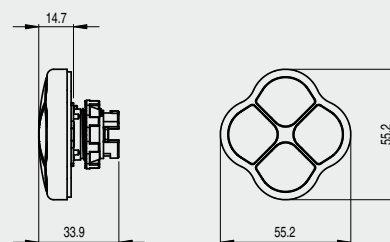

Flush quadruple pushbutton

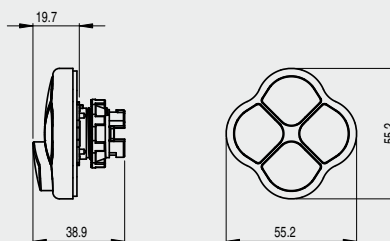

Assembling minimum distances

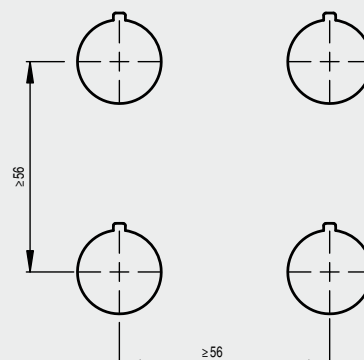

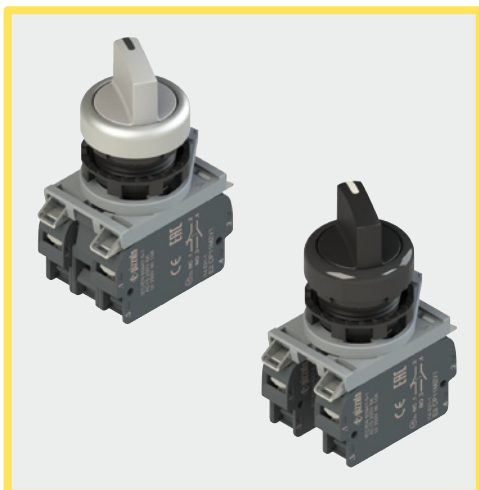

Main features

- Protection degree IP67 and IP69K
- 3 different shapes
- Standard or illuminated versions
- Stay-put or spring-return versions

Markings and quality marks:



Approval EAC: RU C-IT ДМ94.В.01024

In conformity with requirements requested by:

Low Voltage Directive 2006/95/EC, Machinery Directive 2006/42/EC and EMC Directive 2004/108/EC.

Positive contact opening in conformity with standards:

IEC 60947-5-1, EN 60947-5-1, VDE 0660-206.

In conformity with standards:

IEC 60947-1, IEC 60947-5-1, IEC 60204-1, EN 60947-1, EN 60947-5-1, EN 60204-1, UL 508, CSA 22-2 N°14

Technical data

General data

Protection degree:	IP67 according to IEC 60529 IP69K according to ISO 20653
Ambient temperature:	-25°C +80°C
Mechanical endurance:	1 million operations cycles ¹
Max operating frequency:	3600 operations cycles ¹ /hour
Actuating force at end travel:	0.07 Nm (without contacts)
Maximum travel:	±60°
Ring driving torque:	2 ... 2.5 Nm
Utilization requirements:	see page 3/98 of general catalog 2013-2014n

(1) One operation cycle means two movements, one to close and one to open contacts, as foreseen by EN 60947-5-1 standard.

Contact block

Protection degree:	IP20 on the terminals according to IEC 60529
Ambient temperature:	-40°C +80°C
Mechanical endurance:	20 million operations cycles ¹
Max operating frequency:	3600 operations cycles ¹ /hour
(1) One operation cycle means two movements, one to close and one to open contacts, as foreseen by EN 60947-5-1 standard.	
Activating speed:	min 1 mm/s max 0.5 m/s
Contacts material:	silver contacts (standard) Contacts for weak current in silver "V shape" self-cleaning contacts with quadruple contact points
Contacts form:	min 1 x 0.34 mm ² (1 x AWG 22) max 2 x 1.5 mm ² (2 x AWG 16)
Conductors cross section:	min 1 x 0.34 mm ² (1 x AWG 22) max 2 x 1.5 mm ² (2 x AWG 16)
Screw terminal driving torque:	0.6 ... 0.8 Nm

LED holders

Protection degree:	IP20 on terminals according to IEC 60529
Ambient temperature:	-25°C +70°C
Endurance:	100.000 hours (at rated voltage and ambient temperature +25 °C)
Conductor cross section:	min 1 x 0.5 mm ² (1 x AWG 20) max 2 x 2.5 mm ² (2 x AWG 14)
Operation voltage and current: (high luminosity)	12 ... 30 Vac/dc; 5 ... 15 mA 102 ... 138 Vac; 10 ... 12 mA 195 ... 264 Vac; 9 ... 10 mA
Screw terminal driving torque:	0.6 ... 0.8 Nm

⚠ Installation for safety applications:

Use only switches marked with the symbol ⊕. The safety circuit must always be connected with the **NC contacts** (normally closed contacts: 1-2) as stated in the standard ISO 14119, par. 5.4.

Electrical data

Thermal current (I _{th}):	10 A
Rated insulation voltage (U _i):	250 Vac/dc
Protection against short circuits:	fuse 10 A 500 V type gG/gL
Rated impulse withstand voltage (U _{imp}):	4 kV
Pollution degree:	3

Utilization categories

Alternate current: AC15 (50-60 Hz)				
U _e (V)	24	48	120	250
I _e (A)	6	6	6	6
Direct current: DC13				
U _e (V)	24	48	125	250
I _e (A)	2.5	1.3	0.6	0.3

Protection degree IP67 and IP69K

IP69K
IP67

Designed to be employed also in severe environment conditions, Pizzato Elettrica selectors have protection degree IP67 and IP69K, suitable for use in machineries subjected to intense washing with high pressure and high temperature water jets.

Shapes

On request, the selector handgrip can be supplied in different shapes.



short handle





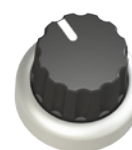









long handle





knob

Complete units with 4 positions selectors selection table

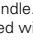









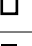

Actuator colour and marking	Contacts			Positions	4 positions		Contacts			illuminated 4 positions	
	pos 2	pos 3	pos 1		black ring	satin chrome ring	pos 2	pos 3	pos 1	black ring	satin chrome ring
black	1NO+1NC	-	1NO+1NC		E2 AC-DXBC2201	E2 AC-DXBC2203	-	-	-	-	-
white	1NO+1NC	-	1NO+1NC		E2 AC-DXBC2209	E2 AC-DXBC2211	1NO+1NC	LED	1NO+1NC	E2 AC-DXBC2257	E2 AC-DXBC2259
red	1NO+1NC	-	1NO+1NC		E2 AC-DXBC2217	E2 AC-DXBC2219	1NO+1NC	LED	1NO+1NC	E2 AC-DXBC2265	E2 AC-DXBC2267
green	1NO+1NC	-	1NO+1NC		E2 AC-DXBC2225	E2 AC-DXBC2227	1NO+1NC	LED	1NO+1NC	E2 AC-DXBC2273	E2 AC-DXBC2275
yellow	1NO+1NC	-	1NO+1NC		E2 AC-DXBC2233	E2 AC-DXBC2235	1NO+1NC	LED	1NO+1NC	E2 AC-DXBC2281	E2 AC-DXBC2283
blue	1NO+1NC	-	1NO+1NC		E2 AC-DXBC2241	E2 AC-DXBC2243	1NO+1NC	LED	1NO+1NC	E2 AC-DXBC2289	E2 AC-DXBC2291
orange	1NO+1NC	-	1NO+1NC		E2 AC-DXBC2249	E2 AC-DXBC2251	1NO+1NC	LED	1NO+1NC	E2 AC-DXBC2297	E2 AC-DXBC2299
black	1NO+1NC	-	1NO+1NC		E2 AC-DXBC2200	E2 AC-DXBC2202	-	-	-	-	-
white	1NO+1NC	-	1NO+1NC		E2 AC-DXBC2208	E2 AC-DXBC2210	1NO+1NC	LED	1NO+1NC	E2 AC-DXBC2256	E2 AC-DXBC2258
red	1NO+1NC	-	1NO+1NC		E2 AC-DXBC2216	E2 AC-DXBC2218	1NO+1NC	LED	1NO+1NC	E2 AC-DXBC2264	E2 AC-DXBC2266
green	1NO+1NC	-	1NO+1NC		E2 AC-DXBC2224	E2 AC-DXBC2226	1NO+1NC	LED	1NO+1NC	E2 AC-DXBC2272	E2 AC-DXBC2274
yellow	1NO+1NC	-	1NO+1NC		E2 AC-DXBC2232	E2 AC-DXBC2234	1NO+1NC	LED	1NO+1NC	E2 AC-DXBC2280	E2 AC-DXBC2282
blue	1NO+1NC	-	1NO+1NC		E2 AC-DXBC2240	E2 AC-DXBC2242	1NO+1NC	LED	1NO+1NC	E2 AC-DXBC2288	E2 AC-DXBC2290
orange	1NO+1NC	-	1NO+1NC		E2 AC-DXBC2248	E2 AC-DXBC2250	1NO+1NC	LED	1NO+1NC	E2 AC-DXBC2296	E2 AC-DXBC2298

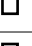
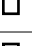
Legend:  Stay-put  Spring-return

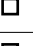
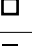
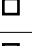
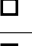
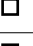
Note: the LED supplied with the illuminated selector has power supply 12 ... 30 Vac/dc. Other voltages on request.

Available on request selector with knob or long handle.
On request selectors with knob may be customized with symbols and inscriptions.

Contacts diagram

Contacts		Selector position			
		I	II	III	IV
pos. 2	.1				
	.3				
pos. 1	.1				
	.3				

■ closed contacts □ open contacts

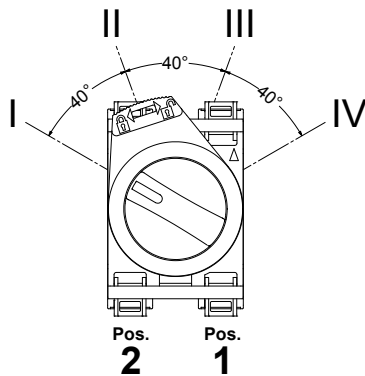

4 positions selectors

The combination of this new version of the selector with the dedicated double contact blocks allows to close a single contact in each of the four positions; the angular rotation of the lever remains the same for versions with 2, 3 and 4 positions, thus facilitating the handling of the device.

The 4 positions selector must not be combined with contact blocks other than those provided.

Assembling minimum distances

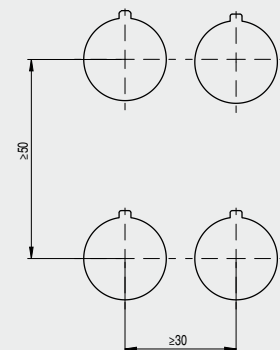

Selection diagram

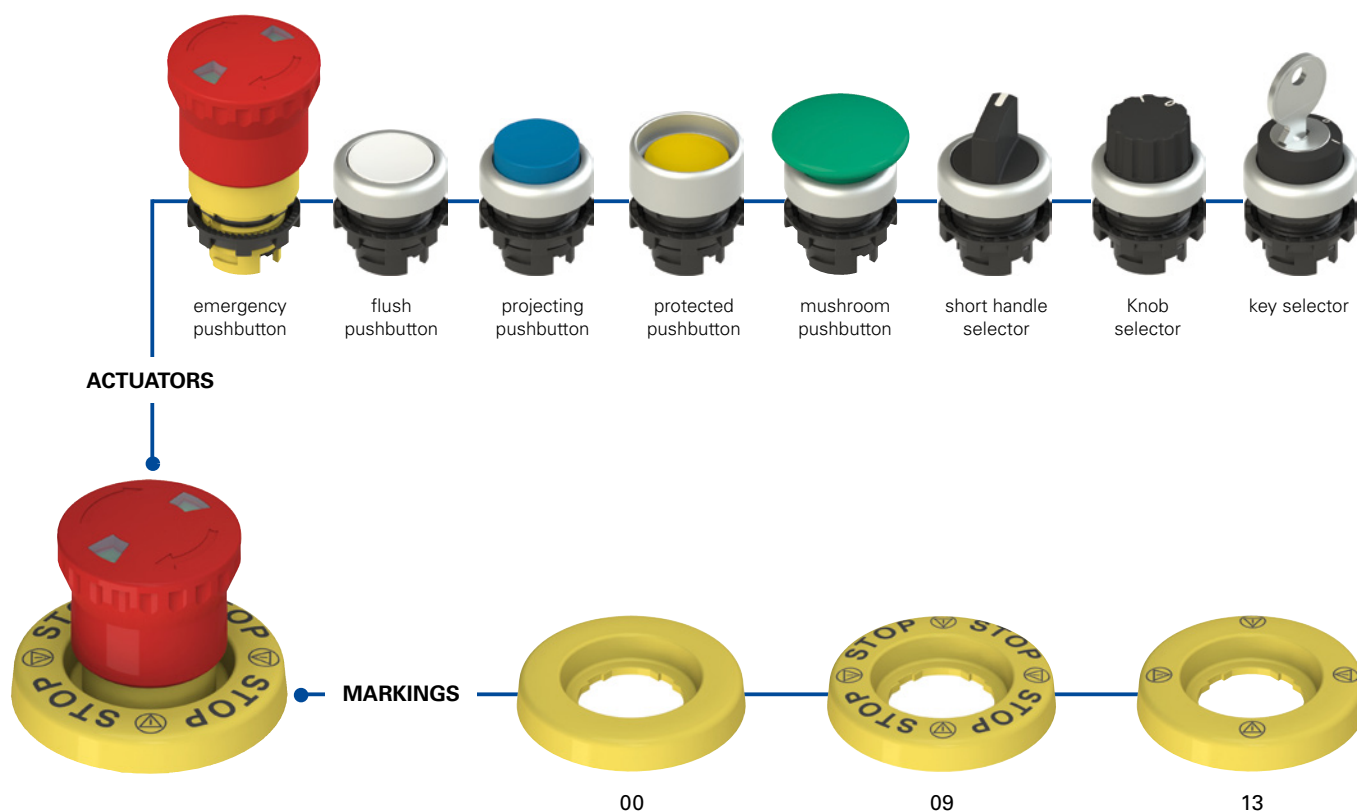

Protection degree IP67

IP67 All the illuminated discs of this series, when installed using the supplied adhesive reach protection degree IP67, this way guaranteeing a total protection also in hard environmental conditions.

Sticking possibility

The illuminated disc can also be installed using the supplied adhesive: simply remove the adhesive protective film placed under the disc. Through sticking, it is possible to get the perfect adhesion to the surface and the IP67 protection degree.

Compact design

This accessory grants high luminosity and uniform light. Its main features include the reduced overall dimensions and the compact shape, which are perfectly in line with the aesthetic style of the EROUND line.

Customizing possibility

In order to satisfy customers' numerous requests and demands, Pizzato Elettrica gives the possibility to customize the luminous discs with markings that are extremely visible thanks to the homogeneous illumination of the device.

High visibility

The use of internal high-luminous LEDs makes the emergency pushbutton immediately recognizable and traceable, in order to grant a safer employment in scarcely illuminated environments, when the device is placed at a certain distance, or in case of scarce visibility. The ideal way to highlight also normal pushbuttons or selectors.

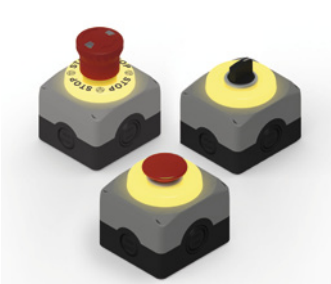

Disco luminoso lampeggiante

The blinking illuminated disc uses the same high brilliancy LED of the fixed light version, which combined with the intermittent function allows to better capture the attention thus making even more visible the application points of the emergency pushbuttons or other devices such as pushbuttons and selectors.

Dimensions

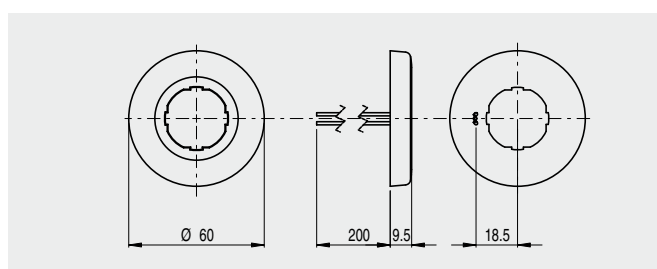



Technical data

General data

Protection degree:	IP67 according to IEC 60529 installed with the adhesive supplied.
Ambient temperature:	-25°C +70°C
Conductor cross section:	2 x 0.25 mm ² (2 x AWG 24)
Laying cable:	Fixed
Min. bend radius:	14 mm
Cable insulation:	PVC
Operation voltage (Un):	24 Vac/dc
Supply voltage tolerance:	±15% of Un
Operation current:	20 mA
Blinking frequency (if supplied):	1 Hz
Utilization requirements:	see page 3/98, general catalog 2013-2014

In conformity with standards:

IEC 60947-1, IEC 60947-5-1, IEC 60204-1, EN 60947-1, EN 60947-5-1, EN 60204-1, UL 508, CSA 22-2 N°14

In conformity with requirements requested by:

Low Voltage Directive 2006/95/EC
Machinery Directive 2006/42/EC
EMC Directive 2004/108/EC.

Main features







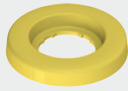

- High visibility
- Protection degree IP67
- Compact design
- Indelible laser marking
- Customizing possibility

Markings and quality marks:

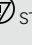

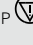
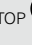



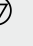

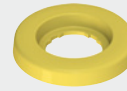

Approval EAC: RU C-IT ДМ94.В.01024

Luminous disc

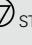
Colour / marking	Article	Description
	VE DL1A5A00	Yellow luminous disc, Ø 60 mm, 24 Vac/dc, no marking
	VE DL1A5A09	Yellow luminous disc, Ø 60 mm, 24 Vac/dc, with marking: STOP  STOP  STOP  STOP 
	VE DL1A5A13	Yellow luminous disc, Ø 60 mm, 24 Vac/dc, with marking:    

Blinking luminous disc

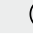
Colour / marking	Article	Description
	VE DL1A5L00	Yellow blinking luminous disc, (0.5s on 0.5s off), Ø 60 mm, 24 Vac/dc, no marking
	VE DL1A5L09	Yellow blinking luminous disc, flashing (0.5s on 0.5s off), Ø 60 mm, 24 Vac/dc, with marking: STOP  STOP  STOP  STOP 
	VE DL1A5L13	Yellow blinking luminous disc, flashing (0.5s on 0.5s off), Ø 60 mm, 24 Vac/dc, with marking:    

Panel drilling and applications

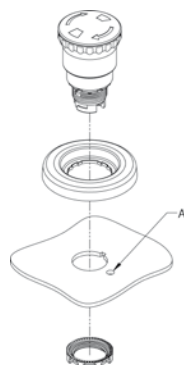
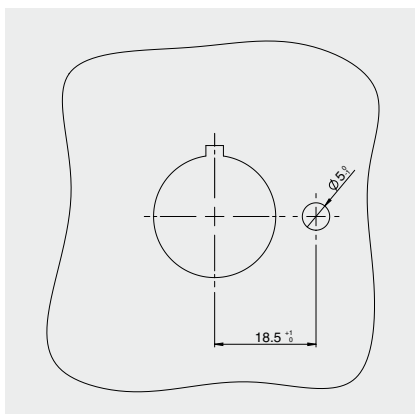

A: Hole dia. 5 mm for cables conveyance

Assembling minimum distances

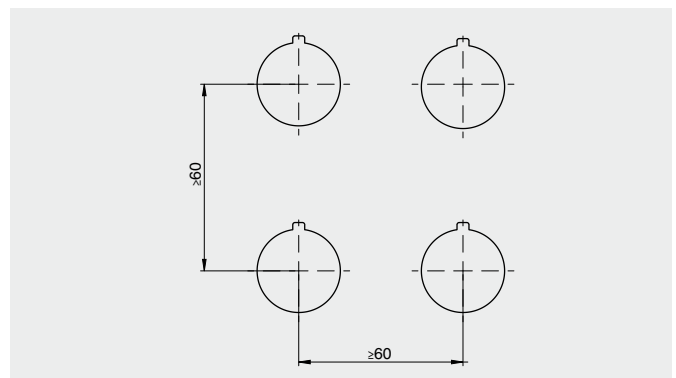

Selection diagram



Code structure

E2 1USB9CAK

Fixing ring and shaped ring		Back connection	
1	ring in plastic	AK	USB Type A integrated female socket
2	ring in plastic and shaped ring	N0.8	outlet with cable in PVC (0.8 m long) and USB Type A male socket
3	ring in metal	N1.8	outlet with cable in PVC (1.8 m long) and USB Type A male socket
4	ring in metal and shaped ring	N3	outlet with cable in PVC (3 m long) and USB Type A male connector
		N5	outlet with cable in PVC (5 m long) and USB Type A male connector

Ring colour		Front connection	
1	black (standard)	A	USB 3.0 Type A integrated female socket
9	satin-finish chrome (standard)	C	USB 2.0 Type A integrated female socket
4	shiny black chrome (on request)		
5	shiny gold (on request)		

Attention! The feasibility of a code number does not mean the effective availability of a product. Please contact our sales office.



Technical data

General data

Connections:

Protection degree:

Ambient temperature:

Ring driving torque:

Utilization requirements:

USB 3.0 or USB 2.0

IP67 according to IEC 60529
with hood closed

-25°C +70°C

2 ... 2.5 Nm

see page 3/98,
general catalog 2013-2014

In conformity with standards:

IEC 60947-1, IEC 60947-5-1, IEC 60204-1, EN 60947-1, EN 60947-5-1, EN 60204-1,
UL 508, CSA 22-2 N°14

In conformity with requirements requested by:

Low Voltage Directive 2006/95/EC

Machinery Directive 2006/42/EC

EMC Directive 2004/108/EC.

Main features

- Two data transfer speeds
- Protection degree IP67
- Version with socket/socket
- Version with socket/cable/male connector

Markings and quality marks:



Approval EAC: RU C-IT ДМ94.В.01024

USB 3.0 High Speed

The USB socket for a 22 mm dia. push-button panel uses latest-generation USB 3.0 connectors, in order to offer maximum data transfer speed. Moreover, the socket is also backward compatible with previous USB connectors.

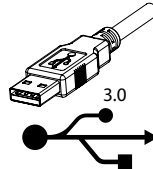

USB 2.0

The USB socket for a 22 mm dia. push-button panel is also available with USB 2.0 connectors and standard data transfer speed. This option offers the best value for money.

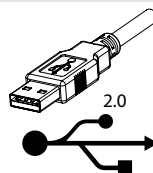

Versions with socket and with cable

To make device installation versatile and suitable for any situation, two versions are offered:

- with female socket-to-female socket connection

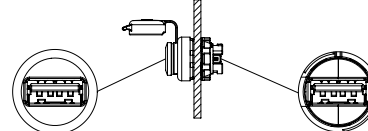

- with female socket-to-cable - male connector (available in different lengths)

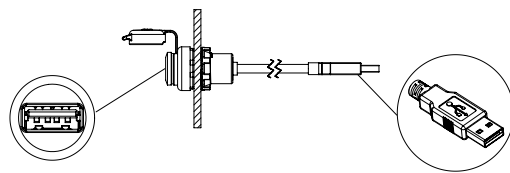

Shaped ring

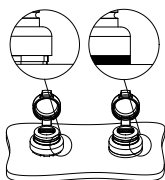

The shaped ring can be used when no label holders or other devices are applied; it prevents dirt and other residues from settling between the pushbutton and the panel or box. This turns out to be particularly useful in the sectors where high standards of cleanness and hygiene are required.

Protection hood

The protection hood integrated in the device ensures maximum strength, preventing any water or dirt from penetrating inside. The hood remains joined to the device even when it is not fastened, so that it cannot be lost; besides, its shape does not stop the plate holder from being mounted.

Dimensions

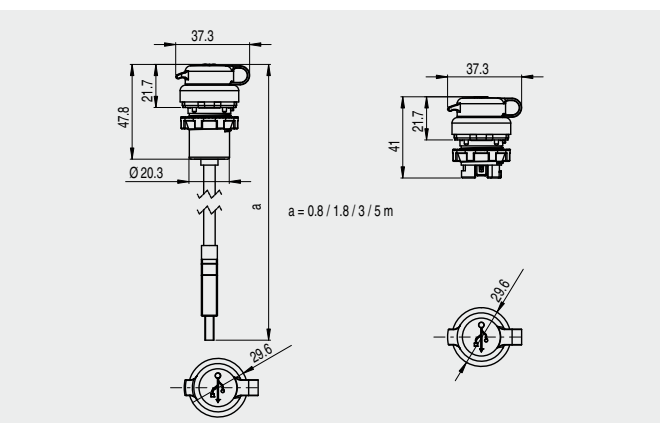

Selection diagram



Code structure

E2 1RJ459AAK

Fixing ring and shaped ring		Back connection	
1	ring in plastic	AK	RJ45 integrated female socket
2	ring in plastic and shaped ring	N1	outlet with cable in PVC (1 m long) and RJ45 male connector
3	ring in metal	N1.5	outlet with cable in PVC (1.5 m long) and RJ45 male connector
4	ring in metal and shaped ring	N2.5	outlet with cable in PVC (2.5 m long) and RJ45 male connector

Ring colour		Front connection	
1	black (standard)	A	RJ45 integrated female socket
9	satin-finish chrome (standard)		
4	shiny black chrome (on request)		
5	shiny gold (on request)		

Attention! The feasibility of a code number does not mean the effective availability of a product. Please contact our sales office.



Technical data

General data

Connection:	RJ45
Protection degree:	IP67 according to IEC 60529 with hood closed
Ambient temperature:	-25°C +70°C
Ring driving torque:	2 ... 2.5 Nm
Utilization requirements:	see page 3/98, general catalog 2013-2014

In conformity with standards:

IEC 60947-1, IEC 60947-5-1, IEC 60204-1, EN 60947-1, EN 60947-5-1, EN 60204-1, UL 508, CSA 22-2 N°14

In conformity with requirements requested by:

Low Voltage Directive 2006/95/EC
Machinery Directive 2006/42/EC
EMC Directive 2004/108/EC.

Main features

- RJ45 connectors
- Protection degree IP67
- Version with socket/socket
- Version with socket/cable/male connector

Markings and quality marks:



Approval EAC: RU C-IT DM94.B.01024

RJ45

The network socket uses RJ45 connectors, for Ethernet networks. Its particular structure makes it possible to bring the Ethernet connection outside the electrical panel, without necessarily needing it to be opened.

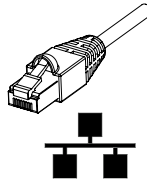

Fixing ring

A fixing ring in metal is also available in addition to the fixing ring in technopolymer.

The fixing ring in metal is particularly suitable for those applications which require tighter fitting of the panel-mounted device, such as for example in metal panels having holes without reference notches. Both rings feature a toothed surface which comes into contact with the inside of the panel in order to make it easier for the device to be secured to the actual panel.

Shaped ring

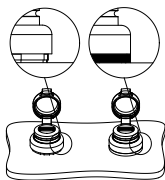

The shaped ring can be used when no label holders or other devices are applied; it prevents dirt and other residues from settling between the pushbutton and the panel or box. This turns out to be particularly useful in the sectors where high standards of cleanness and hygiene are required.

Protection hood

The protection hood integrated in the device ensures maximum strength, preventing any water or dirt from penetrating inside. The hood remains joined to the device even when it is not fastened, so that it cannot be lost; besides, its shape does not stop the plate holder from being mounted.

Versions with socket and with cable

To make device installation versatile and suitable for any situation, two versions are offered:

- with female socket-to-female socket connection

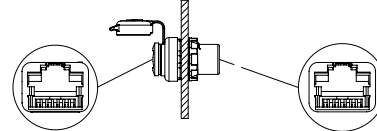

- with female socket / cable / male connector (available in different lengths)

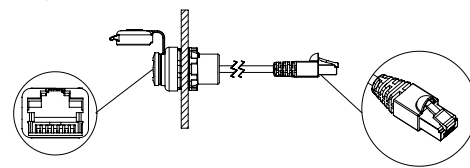

Dimensions

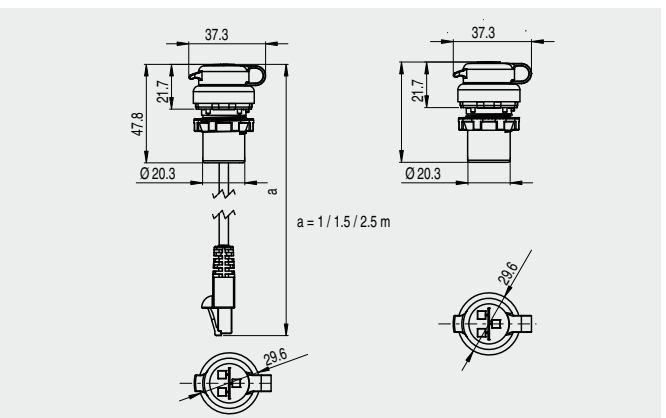



General Catalog



Production program



EROUND
brochure



LIFT
General Catalog



DVD



Web site
www.pizzato.com



pizzato elettrica

Passion for Quality

Pizzato Elettrica s.r.l. Via Torino, 1 - 36063 Marostica (VI) Italy
Phone +39.0424.470.930 - Fax +39.0424.470.955
E-mail: info@pizzato.com - Web site: www.pizzato.com

ZE FGL15A14-ENG

